

SYSTEM 22

MORE STABLE THAN SYSTEM 16,
MORE COST-EFFECTIVE THAN SYSTEM 28



MATERIAL

Material thickness approx. 17 – 19 mm

PROFESSIONAL 750

Steel S355J2+N,
plasma nitrided and BAR-coated



OUR RECOMMENDATION: ANTI-SPATTER TO EVERY WELDING TABLE

The non-flammable, water-soluble Anti-Spatter prevents the adhesion of welding spatters, in addition to the plasma nitration.



¹without Plasma nitration

Unprotected against rust, scratches and welding spatters. Protection against welding spatters is only given by using anti-spatter spray.

Due to the lack of material hardness of Professional 750 significantly higher product wear.

²with Plasma nitration

Well protected against rust, scratches and weld spatter.

BOREHOLE Ø 22 MM

1. Boreholes on the surface in diagonal grid or 100x100 mm grid
2. Boreholes with radius 2,5 mm
3. Radius 3 / 6 mm on table edges and corners
4. Height of table side 150 mm
Borehole spacing of table side 50 mm
5. With scaling on the surface
6. Construction reinforced with ribbing

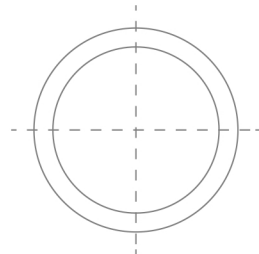

ACCESSORIES-SET 223999

(Free in all sets)

- 220402.N Eccentric Stop
- 220852 Allen Wrench
- 220820 Brush
- 000940 Oilstone
- 000911 Sample CleanBasic
- 000921 Sample Anti-Spatter



TABLES	PROFESSIONAL 750		
	100x100 mm Grid with Plasma nitration ²	Diagonal grid without Plasma nitration ¹	Diagonal grid with Plasma nitration ²
1,0 x 1,0 m 4 Legs approx. 296 kg		4-220010.D ○	4-220010.PD ●
1,5 x 1,0 m 4 Legs approx. 412 kg		4-220035.D ○	4-220035.PD ●
2,0 x 1,0 m 4 Legs approx. 519 kg	4-220020.P ●	4-220020.D ○	4-220020.PD ●
2,4 x 1,2 m 6 Legs approx. 726 kg	4-220030.P ●	4-220030.D ○	4-220030.PD ●
3,0 x 1,5 m 6 Legs approx. 1.073 kg	4-220040.P ●	4-220040.D ○	4-220040.PD ●

● = Item produced for stock ○ = Item produced to order

TABLE LEGS



Item No.	220858	280857.X ³	4-280878.XX	4-280877.XX	4-220866.XX ⁴	4-280879.XX ⁴	4-220874.XX
Capacity per table leg	1.000 kg	2.000 kg	2.000 kg	2.000 kg	800 kg	800 kg	1.000 kg
Leg height	700 mm	750 mm	450 – 700 mm	550 – 900 mm	700 mm	550 – 750 mm	700 mm
Table height	850 mm	900 mm	600 – 850 mm	700 – 1.050 mm	850 mm	700 – 900 mm	850 mm
Fine adjustment	50 mm	50 mm	50 mm	50 mm	20 mm	20 mm	50 mm

³ Standard equipment, alternative height: Available without a surcharge.

⁴ Note caster: Not recommended for welding tables with 6 table legs.

SETS

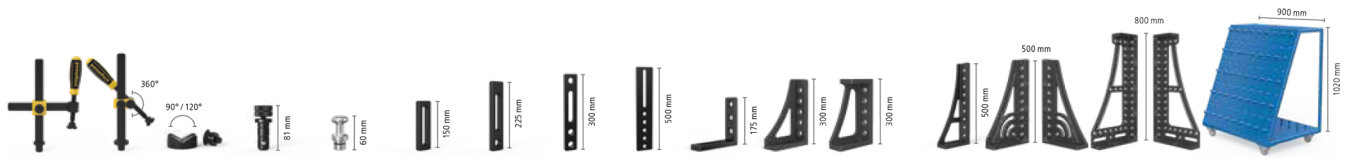

	Clamp	Clamp	Prism	Bolt	Magnetic Bolt	Stop	Stop	Stop	Stop	Square	Square	Square	Square	Rotation Angle	Square	Tool Cart
Material	Burnished	Burnished	Burnished	Burnished	Aluminum	Nitrided	Nitrided	Nitrided	Nitrided	Nitrided	Nitrided	Nitrided	Nitrided	Nitrided	Nitrided	
Item No.	220610	220630	220645.1	220510	220740	220410.N	220420.N	220426.N	220430.N	220110.N	220152.N	220116.N	220162.N	220164+65.N	220144+46.N	220910
Set 1: 4-223100.2	4 x	2 x		12 x		4 x	4 x			2 x	2 x					
Set 2: 4-223200.2	6 x	4 x	4 x	18 x	4 x	6 x	6 x	2 x		4 x	2 x					
Set 3: 4-223300.2	10 x	6 x	4 x	24 x	4 x	8 x	8 x	2 x		6 x	2 x					
Set 4: 4-223400.2	12 x	8 x	8 x	30 x	8 x	10 x	10 x	2 x	2 x	8 x		2 x	2 x	1 x + 1 x		1 x
Set 5: 4-223500.2	14 x	10 x	8 x	30 x	8 x	12 x	12 x	4 x	4 x	10 x		2 x	2 x	1 x + 1 x	1 x + 1 x	1 x

WELDING TABLES

The materials used are fundamental to the high level of hardness and long service life.

The choice of a Siegmund table is a long term saving thanks to the high level of precision engineering and the consistent superior quality.

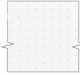
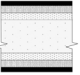

	PROFESSIONAL 750 ¹ without Plasma nitriding	PROFESSIONAL 750 with Plasma nitriding
Hardness in Vickers	Basic hardness approx. 165 – 220 Vickers	Basic hardness approx. 165 – 220 Vickers Surface hardness approx. 450 – 750 Vickers
Material	 Specific base material S355J2-M	 BAR-Coating top nitride transient region Specific base material S355J2-M transient region iron nitride BAR-Coating
Basic hardness	★ ★	★ ★
Surface hardness	★ ★	★ ★ ★ ★ ★ ★
Impact-proof	★ ★	★ ★ ★
Scratch-proof	★ ★	★ ★ ★ ★
Protection against weld spatter	★	★ ★ ★ ★ ★ ★
Corrosion resistance	★	★ ★ ★ ★ ★ ★
Point Load	★ ★ ★	★ ★ ★ ★
Flatness in its new state	★ ★ ★ ★ ★ ★ ★	★ ★ ★ ★ ★ ★ ★
Maintenance of the flatness under heavy use	★	★ ★ ★
Life span	★ ★	★ ★ ★ ★ ★

With our evaluation, we would like to make it easier for you to compare the different materials and to support you in selecting the right welding table.
¹Also applies to all Basic tables System 28.

COMPARISON OF HARDNESS: SURFACE HARDNESS

The plasma nitriding and subsequent BAR-coating protect against scratches, corrosion and welding spatter.

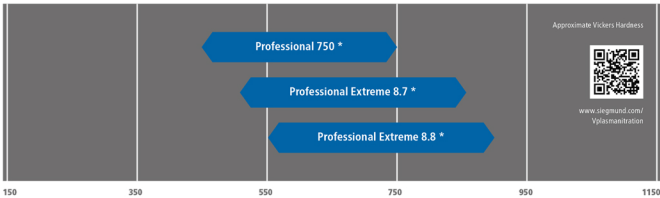

COMPARISON OF HARDNESS: BASIC HARDNESS

The high basic hardness is the essential hardness and allows a high impact resistance and a long service life of the welding table.

